

Stadt Verl

**Straßenendausbau
BP 65 „Hülshorstweg“
in Verl**

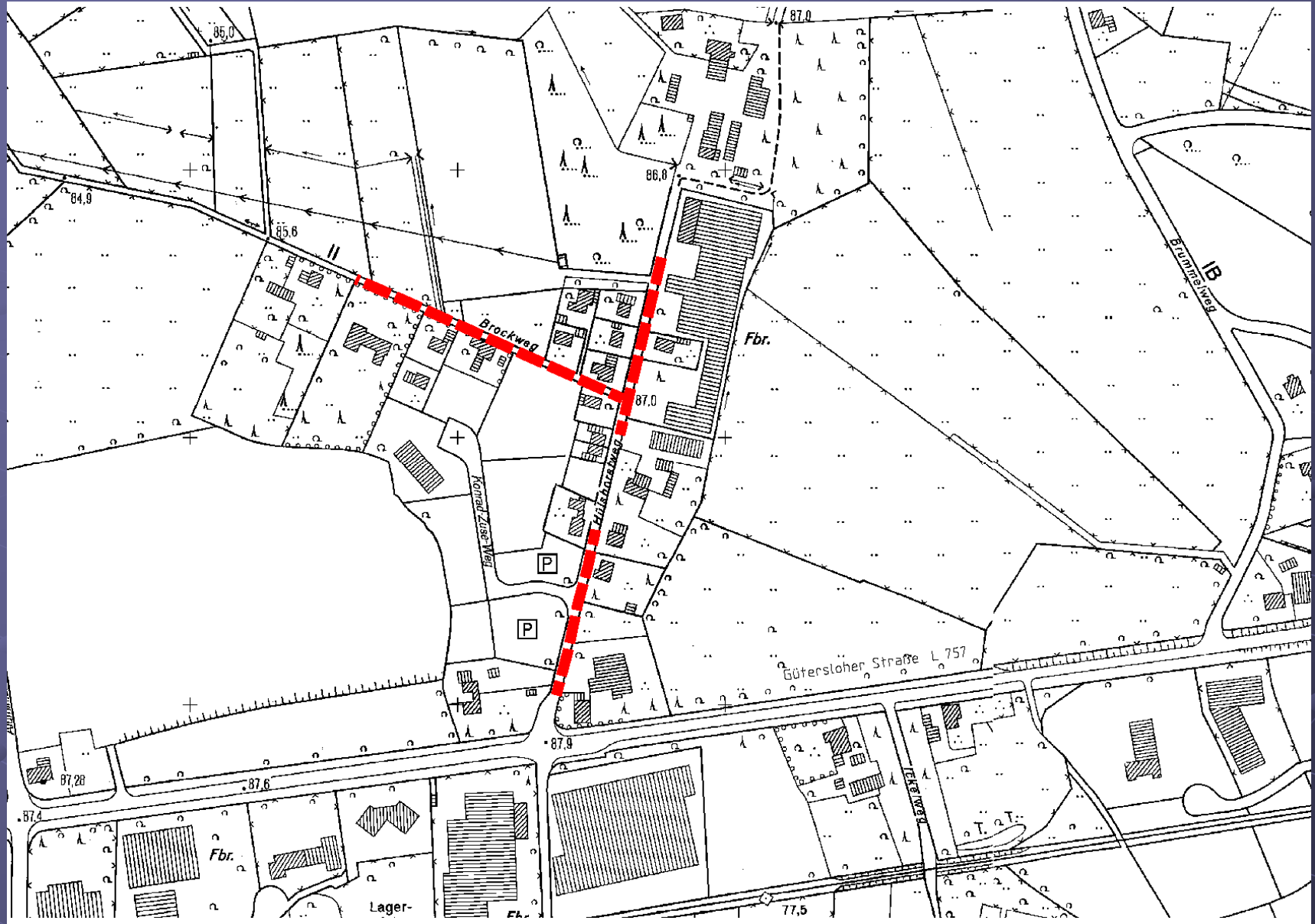

● **Ing. Büro Hegers, Wilhelmshöhe 7, 33102 Paderborn**





F1



F2



F3



F4



F5



F6



F7



F8





F10



F11



F12



F13



Planung

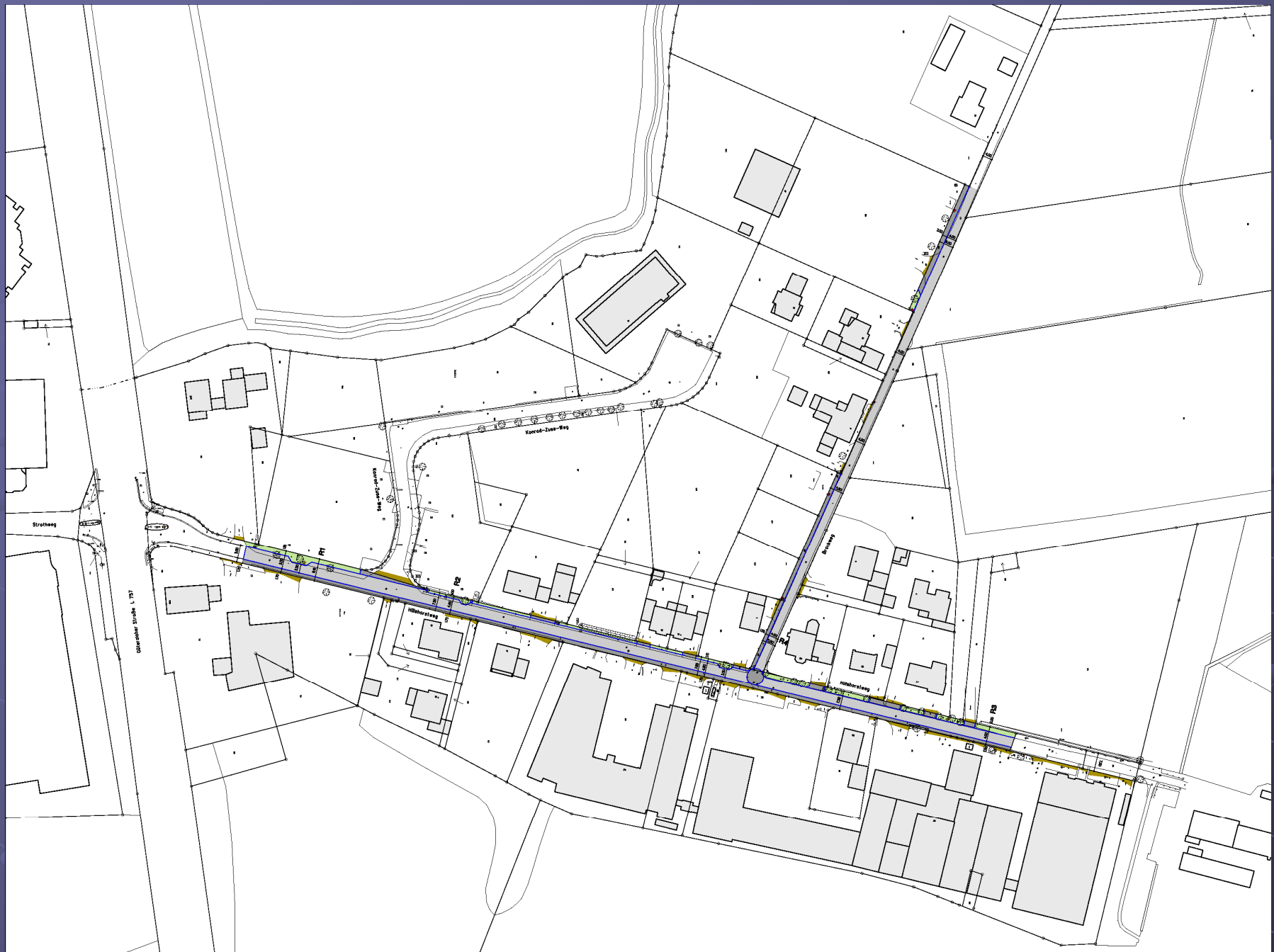

Regelquerschnitt -Hülshorstweg-

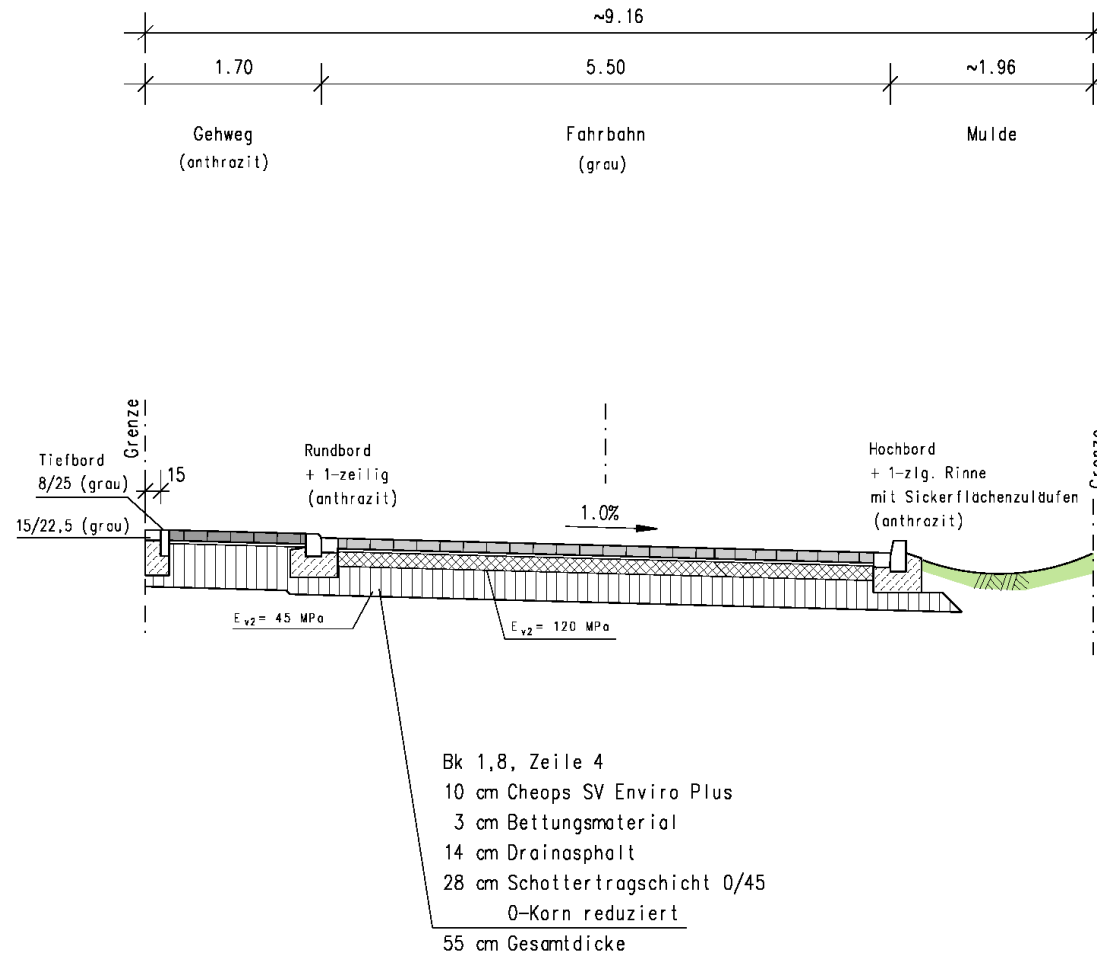

Regelquerschnitt -Hülshorstweg-

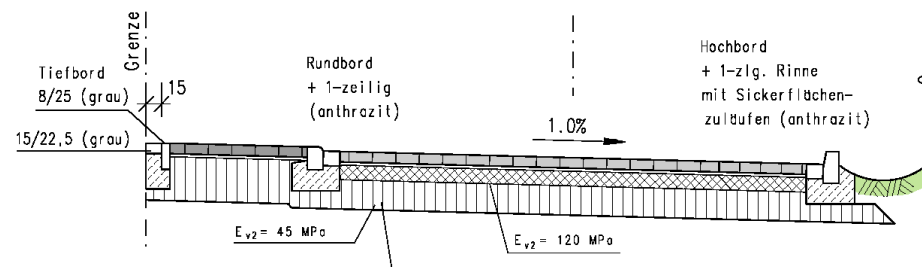
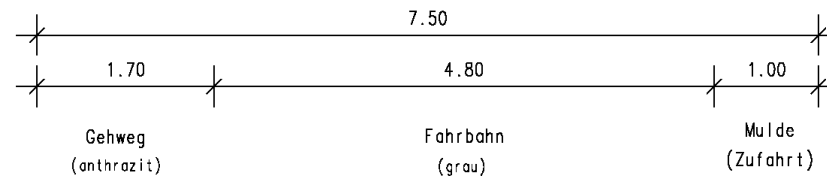

- Bk 1,8, Zeile 4
- 10 cm Cheops SV Enviro Plus
- 3 cm Bettungsmaterial
- 14 cm Drainasphalt
- 28 cm Schottertragschicht 0/45
- 0-Korn reduziert
- 55 cm Gesamtdicke

Regelquerschnitt -Hülshorstweg-

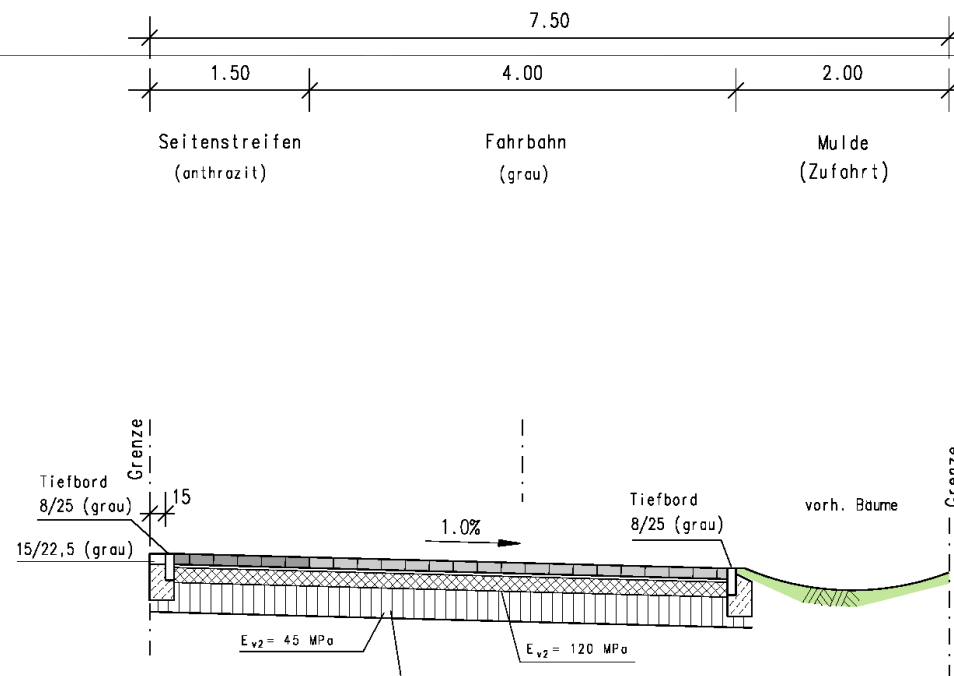

- Bk 1,8, Zeile 4
 10 cm Cheops SV Enviro Plus
 3 cm Bettungsmaterial
 14 cm Drainsphalt
 28 cm Schottertragschicht 0/45
 0-Korn reduziert
 55 cm Gesamtdicke

Regelquerschnitt -Brockweg-

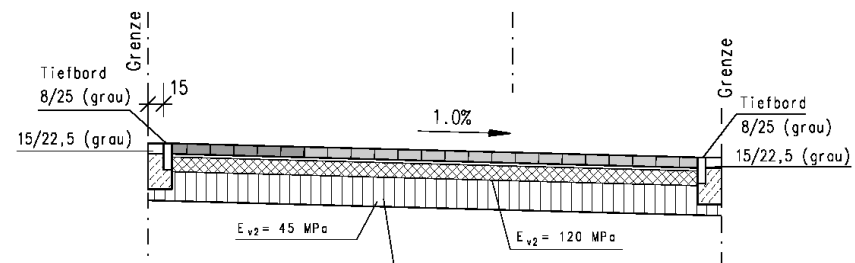
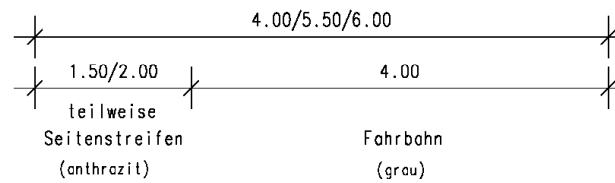

- Bk 1,8, Zeile 4
- 10 cm Cheops SV Enviro Plus
- 3 cm Bettungsmaterial
- 14 cm Drainasphalt
- 28 cm Schottertragschicht 0/45
- 0-Korn reduziert
- 55 cm Gesamtdicke

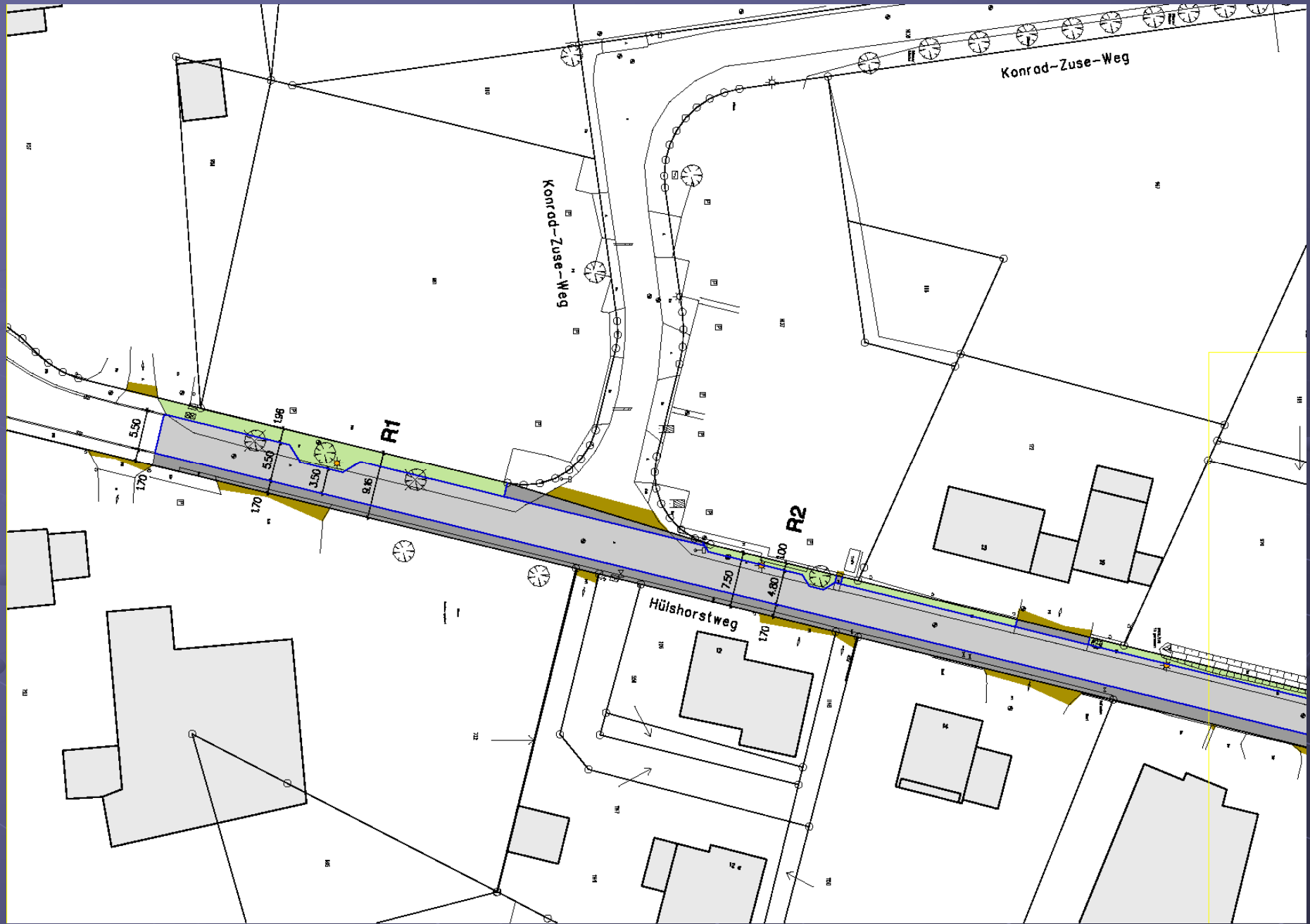



L1-2



L1-3



wasserdurchlässiges Pflaster

F1



F2



F3



Vielen Dank
für Ihre
Aufmerksamkeit!